



HCLNC COIL LIFTER NARROW COIL

FEATURES

- This style of lifter is designed to easily lift and position narrow coils by placing the lifting arm securely through the I.D. of the coil.
- Supplied with standard lifter guide handle and radius on lifting arm to minimize coil damage.
- Engineered and manufactured to ASME B30.20 & BTH-1 Design Category B Service Class 2.
- 100% of ALL coil lifters are Proof-Tested to 125% capacity and certificates supplied at No Additional Charge.
- Made in USA.

OPTIONS

- Higher capacities
- Additional lengths
- Larger throat opening
- Protective padding
- Coil retainer cap
- Parking stands

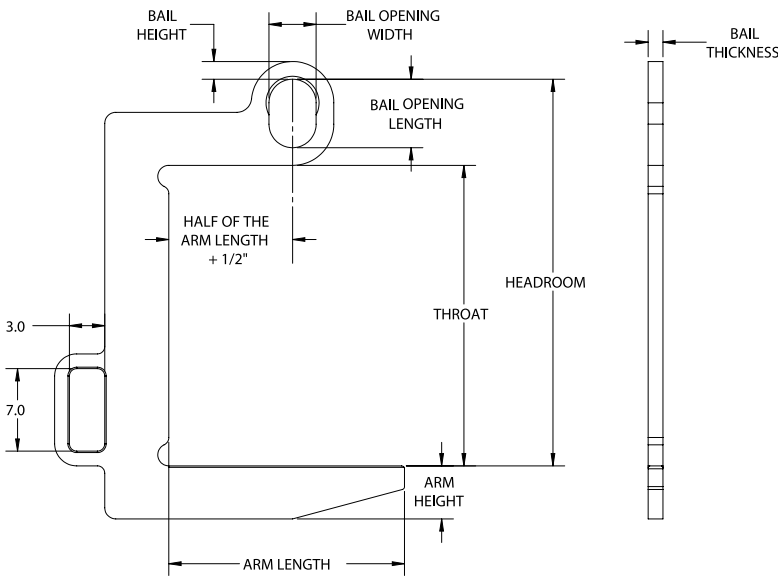
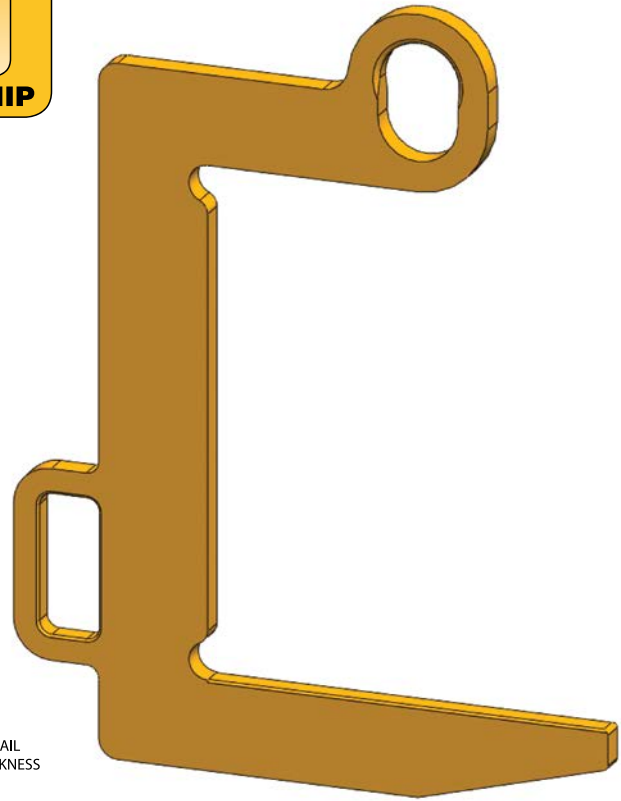

Model #	Capacity (Tons)	Dimensions (Inches)									Weight (Lbs.)
		Coil Width Max	Headroom	Lift Arm Length	Lift Arm Height	Throat Opening Height	Bail Height	Bail Opening Width	Bail Opening Height	Bail Thickness	
HCLNC-1/2-8	1/2	8	18.6	8	2.25	14.5	0.75	2	3.25	0.5	13
HCLNC-1/2-12	1/2	12	18.6	12	2.25	14.5	0.75	2	3.25	0.5	14
HCLNC-1-8	1	8	21.6	8	2.25	17.5	0.81	2	3.25	0.5	15
HCLNC-1-16	1	16	21.6	16	3	17.5	0.81	2	3.25	0.5	22
HCLNC-2-8	2	8	24.5	8	2.5	19.5	1	2.63	4	0.75	27
HCLNC-2-16	2	16	24.5	16	3.25	19.5	1	2.63	4	0.75	41
HCLNC-3.5-12	3.5	12	28.2	12	3.25	21.5	1.19	3.63	5.5	1	57
HCLNC-3.5-16	3.5	16	28.2	16	3.75	21.5	1.19	3.63	5.5	1	69
HCLNC-5-16	5	16	33	16	4	25.5	1.5	4	6	1.25	105
HCLNC-5-20	5	20	33	20	4.5	25.5	1.5	4	6	1.25	121

