

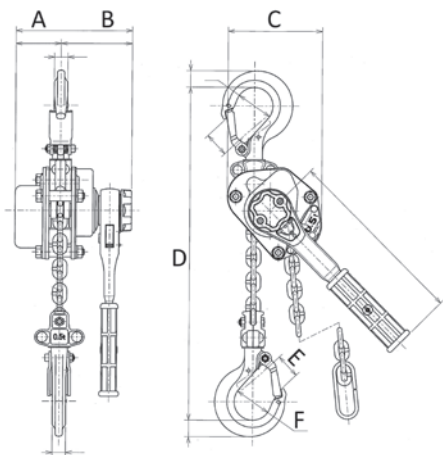

YA LEVER HOIST

Patent and Copyright Registered



YA-50

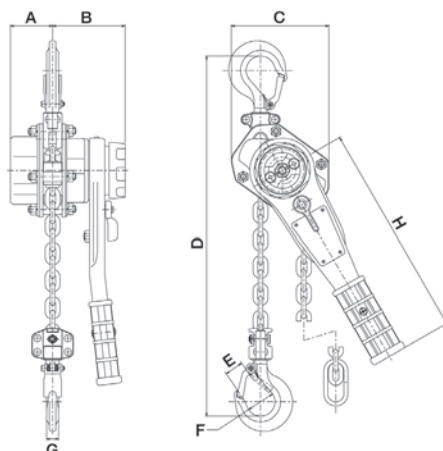

YA-50 ~ 1200, 6t+ has multiple falls

- Rounded lever design for smooth operation when placed against flat surfaces
- Grade 105 galvanized load chain, which adheres to the strict German DIN 5684 standard.
- True one touch free spooling, which automatically brakes when a load is applied.
- Redesigned hooks with tip supporting safety latch
- Hoist body has an electro-deposited black finish for corrosion resistance
- Ratchet recovery of 16.5° for 0.8t~1t and 14° for 1.6t~12t
- Internal side plates have hardened steel bushings for excellent load sheave & pinion support
- Internal side plates, pinion, pawls, and pawl springs have an electro-deposited coating that helps resist corrosion
- Internal disc hub and ratchet wheel are nickel plated for corrosion resistance
- Suitable for operation within a -4° ~ 140° temperature range

SPECIFICATIONS - YA LEVER HOIST

| Model | Capacity (lbs) | Capacity (mt) | Standard Lift (ft) | Hand Effort to Lift Full Working Load (lbf) | Dia. of Load Chain (mm) | Net Weight (lbs) | Load Chain Min Breaking Load | Safety Factor |
|---------|----------------|---------------|--------------------|--|-------------------------|------------------|------------------------------|---------------|
| YA-50 | 1100 | 0.5 | 5 | 82 | 4.3 | 7 | 5.2+ | 5.2 |
| YA-80 | 1760 | 0.8 | 5 | 66 | 5.6 | 13 | 5.2+ | 6.5 |
| YA-100 | 2200 | 1 | 5 | 82 | 5.6 | 14 | 5.2+ | 5.2 |
| YA-160 | 3520 | 1.6 | 5 | 66 | 7.1 | 20 | 8.3+ | 5.3 |
| YA-320 | 7040 | 3.2 | 5 | 82 | 9 | 34 | 13.4+ | 4.2 |
| YA-630 | 13,860 | 6.3 | 5 | 84 | 9 x 2 | 59 | 26.8+ | 4.3 |
| YA-900 | 19,800 | 9 | 5 | 86 | 9 x 3 | 93 | 40.2+ | 4.5 |
| YA-1200 | 26,400 | 12 | 5 | 88 | 9 x 4 | 159 | 53.6+ | 4.2 |

* Test Load is 150% of Rated Load

DIMENSIONS (IN.) - YA LEVER HOIST

| Model | A | B | C | D | E | F | G | H |
|---------|------|------|-------|-------|------|------|------|------|
| YA-50 | 1.7 | 2.7 | 3.6 | 9.4 | 0.94 | 1.4 | 0.51 | 7.0 |
| YA-80 | 2.1 | 3.6 | 4.8 | 11.4 | 0.91 | 1.4 | 0.59 | 10.6 |
| YA-100 | 2.1 | 3.6 | 4.8 | 12.3 | 1.1 | 1.7 | 0.63 | 10.6 |
| YA-160 | 2.5 | 3.9 | 5.4 | 13.9 | 1.2 | 1.7 | 0.83 | 12.2 |
| YA-320 | 3.3 | 4.1 | 7.1 | 16.2 | 1.4 | 2.1 | 1.1 | 12.2 |
| YA-630 | 3.3 | 4.1 | 9.3 | 22.2 | 1.9 | 2.8 | 1.3 | 12.2 |
| YA-900 | 3.3 | 4.1 | 11.8 | 27.1 | 2.9 | 3.4 | 1.88 | 12.2 |
| YA-1200 | 3.25 | 4.09 | 14.57 | 31.06 | 2.91 | 3.35 | 1.87 | 12.2 |

ELEPHANT
LIFTING PRODUCTS™

CALL TOLL-FREE 888-844-6113