

Overload Protection Safety Device, Standard on 1t Capacity and Greater

A High Quality Urethane Paint

Heavy Duty Single Braid Wire Reinforced Air Hose with Swivel Fittings on each end

Galvanized Load Chain for Corrosion Resistance

Meets ASME B30.16 Standards

Pendant Control Machined from Solid Brass for Corrosion Resistant and Spark Resistance with an Emergency Stop Button. Available in Aluminium as well.

Yielding style buffers stall the motor

Upper Hook with a Safety Factor of 5X the Nominal Load

Low-maintenance lubrication free Rotary Vane Motor for clean use within Food Grade, Petrochemical, and Pharmaceutical Environments

Heat Treated and Rust-Free Motor Components with Removable Stainless Steel Cylinder, Allow for Operational Longevity and Low Cost Replacement

Air Valve is 100% Nickel Plated inside and out for Corrosion Resistance.

Infinitely Variable Speed Via Pull Cord Control (not pictured)



Atex approved, EX II 2 GD IIC T4 (X) / EX II 2 GD IIB T4 (X) / EX II 2 GD IIC T4 (X). Additional resistance can be offered with copper platings and stainless steel components.

Trolleys can be offered with 100% Stainless Steel Side Plates and Solid Bronze Wheels.

LME 155



SANS 1638 Compliant



# ATS INDUSTRIAL SERIES AIR CHAIN HOIST 0.25ton-2ton

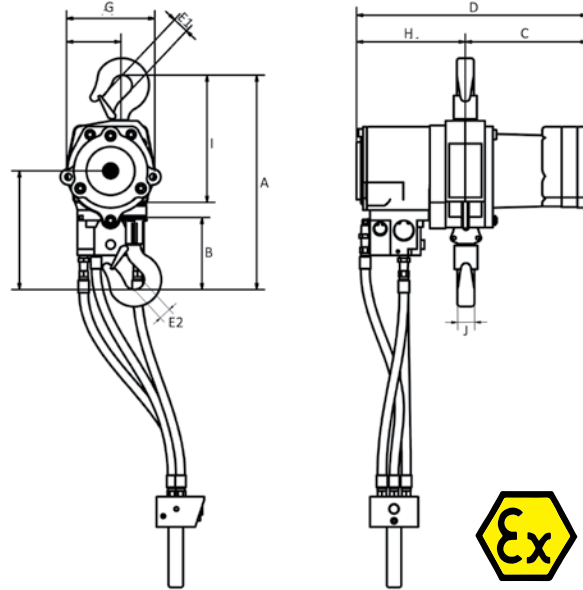

## SPECIFICATIONS - ATS AIR CHAIN HOIST - 0.25ton - 2ton

Specification	Unit	0.25	0.5	1	2
Lifting Capacity	mt	0.25	0.5	1	2
	T	0.27	0.55	1.1	2.2
Number of Fall of Chain		1	1	1	1
Motor Power Output	H.P.	1.9	1.9	1.9	2.4
	kW	1.4	1.4	1.4	1.8
Weight with Pull Cord	lbs.	55	55	64	72
Weight with Pilot Pendant	lbs.	62	62	71	79
Chain Weight Per Additional Foot of Lift	lbs.	0.75	0.75	0.75	1.5
Chain Dimension	mm	7x21	7x21	7x21	9x27
Air Pressure	PSI	87	87	87	87
	bar	6	6	6	6
Air Consumption at Full Load	cfm	60-75	60-75	60-75	95
	m <sup>3</sup> /min	1.75	1.75	1.75	1.75
Air Hose Connection	1" BSP				
Air Hose Dimension	3/4" (19mm - 25mm)				
Lifting Speed at Full Load	ft. / min.	89	62	19	29
Lifting Speed without Load	ft. / min.	98	98	26	43
Lower Speed with Full Load	ft. / min.	108	108	24	45
Standard Lift	ft.	10	10	10	10
Length of Control for Standard Lift	ft.	6.5	6.5	6.5	6.5
Noise Level	84 DbA @ 1m				

## DIMENSIONS - ATS AIR CHAIN HOIST - 0.25ton - 2ton

Type		0.25 ton	0.5 ton	1 ton	2 ton
A min. headroom	inch	12.8	12.8	12.8	12.8
	mm	325	325	325	325
B	inch	4.0	4.0	4.7	4.7
	mm	102	102	120	120
C	inch	3.9	3.9	8.0	8.0
	mm	99	99	202	202
D	inch	10.8	10.8	15.0	15.0
	mm	274	274	382	382
E1	inch	0.9	0.9	1.3	1.3
	mm	22	22	32	32
E2	inch	0.9	0.9	1.3	1.3
	mm	22	22	32	32
G maximum width	inch	5.7	5.7	5.7	5.7
	mm	146	146	146	146
H	inch	6.9	6.9	7.1	7.1
	mm	175	175	180	180
I	inch	7.7	7.7	8.3	8.3
	mm	196	196	211	211
J (hook Width)	inch	0.7	0.7	0.9	0.9
	mm	19	19	23	23

\* Chain containers will increase headroom



# ATS INDUSTRIAL SERIES AIR CHAIN HOIST 3ton-10ton

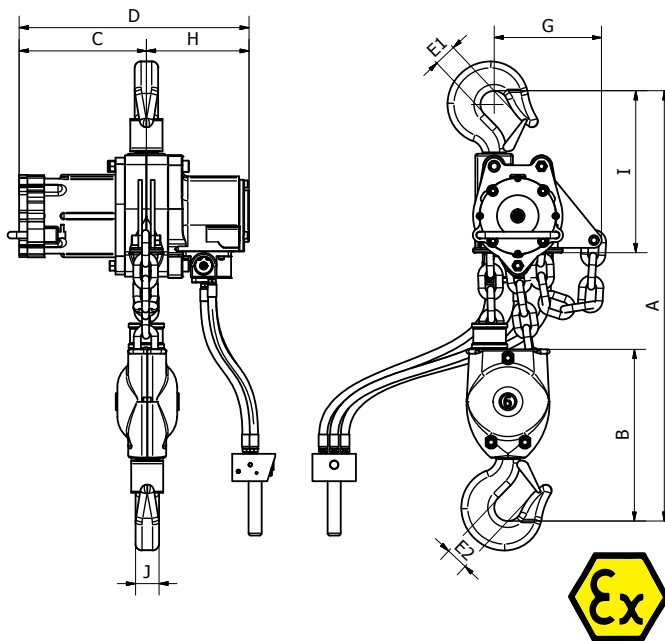

SPECIFICATIONS - AIR CHAIN HOIST - 3ton - 10ton						
Lifting Capacity	mt	3	4.2	5	6	10
	T	3.3	4.6	5.5	6.6	11
Number of Fall of Chain		1	1	1	2	2
Motor Power Output	H.P.	2.4	3.3	3.3	2.4	3.3
	kW	1.8	2.5	2.5	1.8	2.5
Weight with Pull Cord	lbs.	130	160	162	171	267
Weight with Pilot Pendant	lbs.	137	167	169	178	274
Chain Weight Per Add'l Foot of Lift	lbs.	2.6	2.5	4	5.2	8
Chain Dimension	mm	13 x 36	13 x 36	16 x 45	13 x 36	16 x 45
Air Pressure	PSI	72-102	72-102	72-102	72-102	72-102
	bar	5-7	5-7	5-7	5-7	5-7
Air Consumption at Full Load	cfm	110	110	110	110	110
	m3/min	1.75	1.75	1.75	1.75	1.75
Air Hose Connection	3/4" BSP					
Air Hose Dimension	3/4" (19mm - 25mm)					
Lifting Speed at Full Load	ft. / min.	18.3	8.5	8.5	9.3	4.2
Lifting Speed without Load	ft. / min.	23.75	9.8	18.3	13.1	9.1
Lower Speed with Full Load	ft. / min.	25.4	11.4	2.4	14.3	11.8
Standard Lift	ft.	10	10	10	10	10
Length of Control for Standard Lift	ft.	6.5	6.5	6.5	6.5	6.5
Noise Level	84 DbA @ 1m					

DIMENSIONS - ATS AIR CHAIN HOIST - 3ton - 10ton						
Type		3 ton	4.2 ton	5 ton	6 ton	10 ton
A min. headroom	inch	20.6	22.6	24.5	25.6	31.5
	mm	522	575	623	650	800
B	inch	8.9	10.8	10.8	13.1	12.6
	mm	225	275	275	333	320
C	inch	9.2	10.5	10.7	9.2	10.5
	mm	234	266	271	234	267
D	inch	18.9	17.9	18.3	18.9	20.5
	mm	480	454	464	480	521
E1	inch	1.6	1.7	1.7	1.6	1.7
	mm	40	42	42	40	42
E2	inch	1.6	1.7	1.7	1.6	1.7
	mm	40	42	42	40	42
G maximum width	inch	9.4	7.8	11.2	9.4	13.4
	mm	240	198	285	240	340
H	inch	9.7	9.7	7.6	9.7	10.0
	mm	246	246	193	246	254
I	inch	11.8	188	13.8	16.7	18.9
	mm	299	11.7	351	423	480
J (hook Width)	inch	1.8	3.1	3.1	1.9	2.1
	mm	45	80	80	48	53

\* Chain containers will increase headroom



# ATS INDUSTRIAL SERIES AIR CHAIN HOIST 15ton-25ton

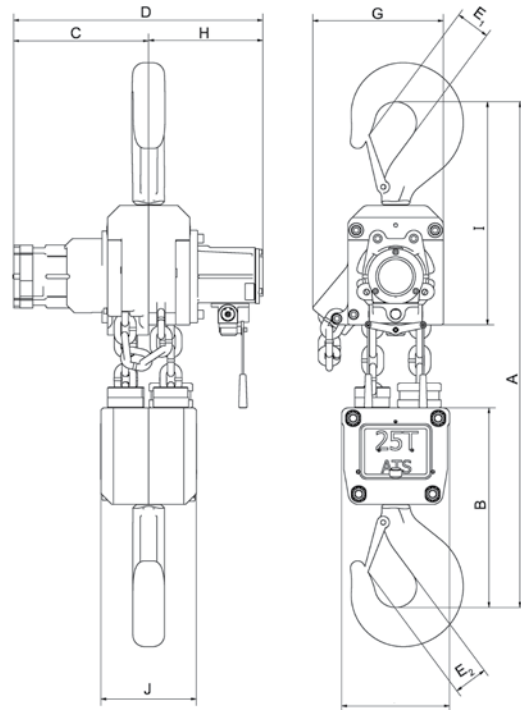

## SPECIFICATIONS - AIR CHAIN HOIST - 15ton - 25ton

Specifications	Unit	15	20	25
Lifting Capacity	mt	15	20	25
	T	16.5	22	27.5
Number of Fall of Chain		4	4	4
Motor Power Output	H.P.	3.4	3.4	6.7
	kW	2.5	2.5	5
Weight with Pull Cord	lbs.	518	683	794
Weight with Pilot Pendant	lbs.	525	690	801
Chain Weight Per Additional Foot of Lift	lbs.	3.75	6.25	7.5
Chain Dimension	mm	13 x 36	16 x 45	16 x 45
Air Pressure	PSI	87	87	87
	bar	6	6	6
Air Consumption at Full Load	cfm	110	110	110
	m3/min	1.75	1.75	1.75
Air Hose Connection	1" BSP			
Air Hose Dimension	3/4" (19mm - 25mm)			
Lifting Speed at Full Load	ft. / min.	2.9	2.1	1.7
Lifting Speed without Load	ft. / min.	6.1	4.6	4.5
Lower Speed with Full Load	ft. / min.	4.8	5.9	6
Standard Lift	ft.	10	10	10
Length of Control for Standard Lift	ft.	6.5	6.5	6.5
Noise Level	84 DbA @ 1m			

## DIMENSIONS - ATS AIR CHAIN HOIST - 15ton - 25ton

Type		15	20	25
A min. headroom	inch	37.0	38.5	40.5
	mm	940	979	1028.0
B	inch	17.1	18.0	19.4
	mm	434	457	494.0
C	inch	10.5	10.5	10.5
	mm	267	267	267.0
D	inch	20.5	20.5	20.5
	mm	521	521	521.0
E1	inch	1.9	1.9	2.2
	mm	48	48	56.0
E2	inch	1.9	1.9	2.2
	mm	48	48	56.0
G maximum width	inch	21.3	24.9	27.6
	mm	541	633	700.0
H	inch	10.0	10.0	10.0
	mm	254	254	254.0
I	inch	20.2	18.6	19.4
	mm	514	472	494.0
J (hook Width)	inch	2.5	2.5	2.8
	mm	63	63	71.0

\* Chain containers will increase headroom



# ATS INDUSTRIAL SERIES AIR CHAIN HOIST 30ton-40ton

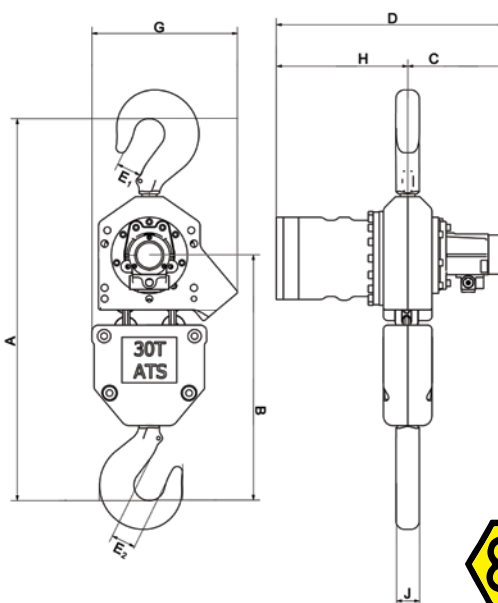

SPECIFICATIONS - ATS INDUSTRIAL SERIES - 30ton - 40ton				
Lifting Capacity	mt	30	37-40	
	T	33	40-44	
Number of Fall of Chain		2	3	
	Motor Power Output	H.P.	6.7	6.7
		kW	5	5
Weight with Pull Cord	lbs.	1124	1940	
Weight with Pilot Pendant	lbs.	1134	1950	
Chain Weight Per Additional Foot of Lift	lbs.	15	25	
Chain Dimension	mm	23.5x66	23.5x66	
Air Pressure	PSI	87	87	
	bar	5-7	5-7	
Air Consumption at Full Load	cfm	155	155	
	m3/min	4.4	4.4	
Air Hose Connection	1" BSP			
Air Hose Dimension	1" (25mm)			
Lifting Speed at Full Load	ft. / min.	2.9	2.3	
Lifting Speed without Load	ft. / min.	3.9	3.2	
Lower Speed with Full Load	ft. / min.	6.5	4.5	
Standard Lift	ft.	10	10	
Length of Control for Standard Lift	ft.	6.5	6.5	
Noise Level	84 DbA @ 1m			

DIM. - ATS INDUSTRIAL SERIES - 30ton - 40ton			
Type		30	37 - 40
A min. headroom	inch	49.4	57.4
	mm	1256.0	1458.0
B	inch	31.3	35.0
	mm	496.0	890.0
C	inch	12.4	15.7
	mm	316.0	400.0
D	inch	18.6	35.5
	mm	474.0	903.0
E1	inch	2.9	4.4
	mm	75.0	113.0
E2	inch	2.9	4.4
	mm	75.0	113.0
G maximum width	inch	18.8	18.0
	mm	478.0	456.0
H	inch	16.9	19.8
	mm	431.0	503.0
J (hook Width)	inch	4.1	4.1
	mm	106.0	106.0

\* Chain containers will increase headroom



# ATS INDUSTRIAL SERIES AIR CHAIN HOIST 50ton-100ton

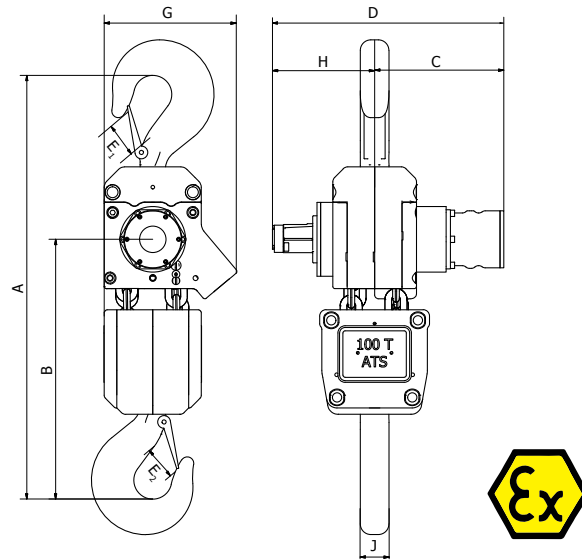

## SPECIFICATIONS - ATS INDUSTRIAL SERIES- 50ton - 100ton

Lifting Capacity	mt	50-60	100
	T	55-66	110
Number of Fall of Chain		4	4
Motor Power Output	H.P.	4.2	4.2
	kW	3.2	3.2
Weight with Pull Cord	lbs.	2,028	5,027
Weight with Pilot Pendant	lbs.	2,036	5,037
Chain Weight Per Additional Foot of Lift	lbs.	33	57
Chain Dimension	mm	23.5x66	32x90
Air Pressure	PSI	87	87
	bar	5 to 7	5 to 7
Air Consumption at Full Load	cfm	160	160
	m3/min	6.2	6.2
Air Hose Connection	1.5" BSP		
Air Hose Dimension	1.5" (38mm)		
Lifting Speed at Full Load	ft. / min.	1.4	1
Lifting Speed without Load	ft. / min.	4.2	2.3
Lower Speed with Full Load	ft. / min.	3.2	2.6
Standard Lift	ft.	10	10
Length of Control for Standard Lift	ft.	6.5	6.5
Noise Level	84 DbA @ 1m		

## DIMENSIONS - ATS INDUSTRIAL SERIES - 50ton - 100ton

Type		50-60	100
A min. headroom	inch	58.1	78.9
	mm	1476	2006
B	inch	35.7	48.2
	mm	907	1230
C	inch	17.4	19
	mm	443	484
E1	inch	3.9	4.9
	mm	100	125
E2	inch	3.9	4.9
	mm	100	125
G maximum width	inch	17.8	24.6
	mm	453	625
H	inch	15.7	24
	mm	400	612
I	inch	33.1	43
	mm	843	1096
J	inch	4.1	6.2
	mm	106	160

\* Chain containers will increase headroom





# AIR CHAIN HOIST WITH MOTORIZED TROLLEY

SPECIFICATIONS - ATS MOTORIZED TROLLEYS - 0.25 ton - 3ton

		ATSI-025	ATSI-050	ATSI-1	ATSI-2	ATSI-3
		TM2t				TM3t
Trolley Carrying Capacity	mt	2				3
	T	2.2				3.3
Carrying Capacity of hoist with trolley	mt	0.25	0.5	1	2	3
	T	0.27	0.55	1	2.2	3.3
Trolley Weight	lbs.	75				82
Hoist Weight with 10 ft. lift	lbs.	57	57	70	78	130
Total weight with 10 ft. lift and trolley	lbs.	132	132	145	153	212
Weight of Chain per ft. lift	lbs. / ft.	0.7			1.2	1.8
Chain Size		7 x 21			9 x 27	13 x 36
Number of chain strands		1				
Air Pressure Trolley Motor	bar	4-6				
Trolley motor air consumption (full load)	cfm	50				
Hoist motor air consumption (full load)	cfm	60-75			95	110
Motor Power Output Trolley	kW	0.3				
	HP	0.4				
Motor Power Output Hoist	kW	1.4			1.8	
	HP	1.9			2.4	
Traveling Speed (6 Bar)	m/min	12				
	ft. / min	39				
Hose Connection Motorized Trolley	mm	13			19	
	inch	0.5			0.75	
Minimum Beam Radius	m	1.5				1.5
	ft.	4.92				4.92
Maximum Bottom Flange width	mm	280				300
	inch	11				11.8
Minimum bottom Flange width	mm	65				70
	inch	2.5				2.75
Noise Level at Motorized Trolley	dBA	84				



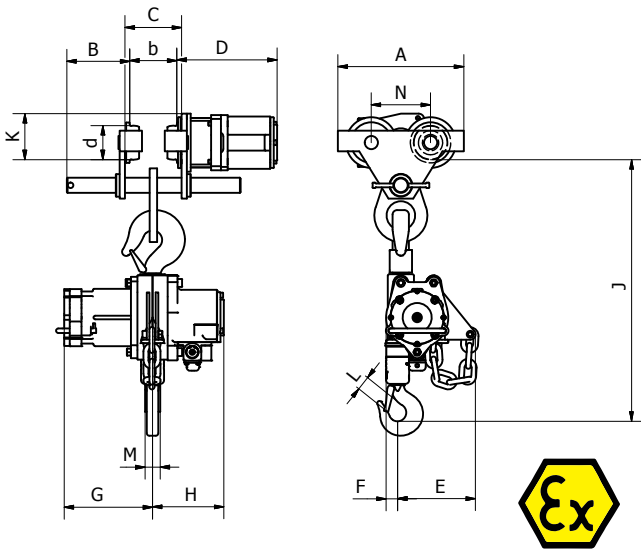

- Motorized trolleys available for the ATSI & Rigger Series
- For hoist capacities greater than 20 ton, see the Monorail Style Units
- Air motor has a polished stainless steel cylinder
- Anti-tip and anti-drop devices
- Manufactured with high quality steel components, allowing for a compact design
- Available with spark resistant features
- Available with marine paint finish

		DIMENSIONS - ATS MOTORIZED TROLEYS - 0.25ton - 3ton				
		ATSI-025	ATSI-050	ATSI-1	ATSI-2	ATSI-3
A	mm	TM2t			TM3t	
	inch	330			330	
B	mm	59			59	
	inch	2.3			2.3	
C	mm	b + 24			b + 25	
	inch	b + 0.95			b + .98	
d	mm	90			90	
	inch	3.5			3.5	
D	mm	263			266	
	inch	10.4			10.5	
E	mm	106		104	206	
	inch	4.2		4	8.1	
F	mm	39		42	30	
	inch	1.5		1.7	1.2	
G	mm	139	193		234	
	inch	5.5	7.6		9.2	
H	mm	179		182	189	
	inch	7	7		7.4	
J* (Lug Mount)	mm	398		395	490	
	inch	15.6		15.5	19.2	
J* (Hook Mount)	mm	496		505	692	
	inch	19.5		19.8	27.2	
K	mm	122			122	
	inch	4.8			4.8	
L	mm	23			30	
	inch	0.9			1.1	
M	mm	23			40	
	inch	0.9			1.6	
N	mm	157			157	
	inch	62			62	

